

PRELIMINARY
ISSUE DATE
13.12.04

NOTE: THIS DRAWING HAS BEEN ROTATED

ACKNOWLEDGEMENTS

Topographical data sourced from NPWS arcinfo
Contour data sourced from 5825-2S
Topographical Map

NSW Department of Public Works and Services:
- Perisher Range Resorts Master Plan

Connell Wagner:
- Perisher Range Resorts Environmental
Study, R2 May '01

National Parks and Wildlife Service:
- Strategy Report - 05/03/02
- Design and construction of water
supply Infrastructure for Perisher Range
water supply upgrade.

WARNING!
BEWARE OF UNDERGROUND SERVICES
The location of underground services are approximate only and their exact position should be proven on site. No guarantee is given that all existing services are shown

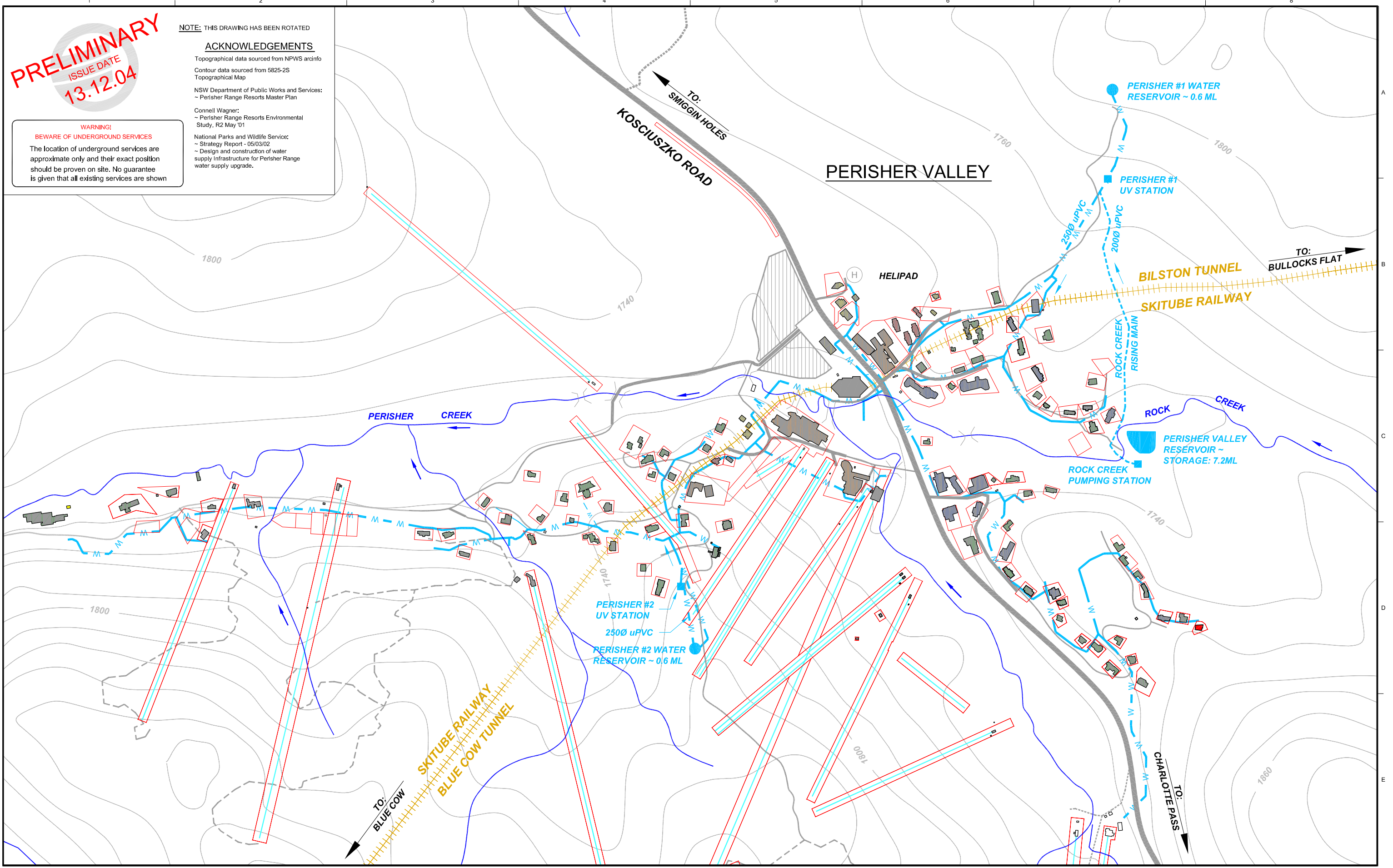

engineering
planning
urban design
EARTH TECH
surveying
landscape architecture
project management
sustainability managers

REVISION	DATE	ZONE
C	Changes as per Draft Report 3	13.12.04
B	Changes as per Draft Report 2	29.11.04
A	Initial Release	04.11.04

LEGEND

- Carparks
- Existing Water
- Highway
- Secondary Paved Road
- Secondary Unpaved Road
- Vehicular Track

NOTE: Contours at 20m Intervals

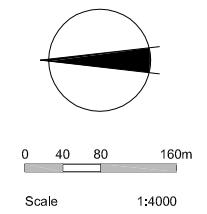

EARTH TECH
Global Technology Consultants
Shepparton - Tel 5831 8777

Designed: Michael Welk, October 2004
Drawn: Andrew Gall, October 2004
Checked:
Approved:

Independent Pricing & Regulatory Tribunal of NSW
Review of Perisher Capital and Operating Costs
Perisher Valley Water Infrastructure
Drawing No. 2004342-05 Rev C
Sheet No. 6
© Earth Tech Engineering ABN 61 089 482 888 A1